

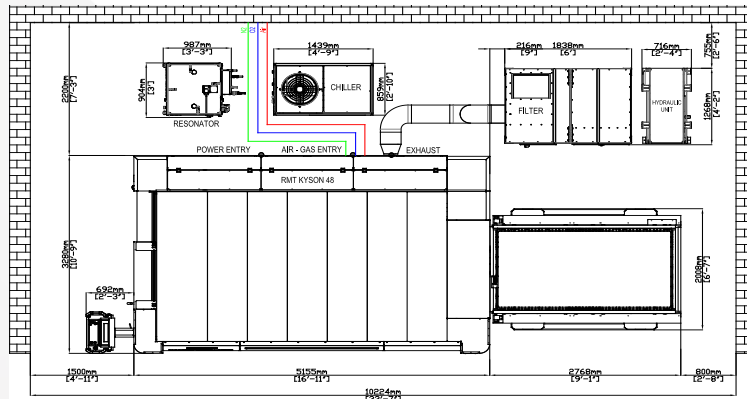

KYSON 48

Readily available up to 15 kW

Size		4' x 8'		
Model Number		Kyson 48-0.5	Kyson 48-1	Kyson 48-2
Laser light source		500 W	1 kW	2 kW
Conservative Production Cutting Capacity **	Mild Steel Oxygen	.197"	.375"	.625"
	Mild Steel Nitrogen	.075"	.125"	.250"
	Stainless Steel	.125"	.187"	.375"
	Aluminum	.075"	.125"	.312"
	Brass	.035"	.081"	.187"
	Copper	.035"	.075"	.187"
Laser Fiber Diameter *		.002" (50 µm)	.002" (50 µm)	.004" (100 µm)
Pulse Peak Power		500 W	1 kW	2 kW
Average Power Consumption (220v/460v 3ph ± 10%)		15 kW	17 kW	21 kW
Pulse Mode		Freq: 5 - 5000Hz Duty: 0 - 100%		
Power Stability		± 0.5 % (power monitor)	± 1-3% (power monitor)	± 1-2% (power monitor)
Beam Mode		Direct		
Protection of Laser Beam		Industrial Fiber Cable		
Laser Gas Composition		N/A		
Cooling Water Flow Rate		1.58 gpm (6 l/m)	2.11 gpm (8 l/m)	2.64 gpm (10 l/m)
CNC Controller & Operator Panel		15" Touch Display, Ethernet Enabled, 6GB RAM with 8 GB Cfast Card		
Axis Movement		High Speed 4 Axes Servo Motor System		
Positioning System		Rack and Pinion		
Axis Speed (X,Y Traverse Speed)		7,874 IPM (200 m/min)		
Acceleration		3G		
Control Input Resolution		0.0001 inch		
Repeatability		± .0004" (± 0.01mm)		
Positioning Accuracy		± .0012" (± 0.03mm)		
Axis	Y AXIS	4' 2" (1270mm)		
	X,U AXIS	8' 4" (2550mm)		
	Z AXIS	5.9" (150 mm)		
Sheet Dimensions		4' 1"x 8' 2" (1250x2500mm)		
Maximum Load Capacity		1,322 lbs (600 kg)		
Shuttle Table Change Time		Double pallet system. Exchange time 30 sec with max sheet weight		
Z - Axis Distance Control		Non-Contact		
ASSIST GAS	Mild Steel	Oxygen 7.25 - 87 PSI (0.5-6 Bar)		
	Stainless Steel	Nitrogen 7.25 - 362 PSI (0.5-25 Bar)		
	Aluminum	Dry Air or Nitrogen 7.25 - 362 PSI (0.5-25 Bar)		
Cutting Head		Precitec Light Cutter		Precitec Procutter (Auto Focus)
CAD/CAM Software		RADAN CAD / CAM		
Machine Dimensions (L x W x H)		340" x 130" x 85" (8615x3280x2155mm)		
Machine Weight		22,928 lbs (10,400 kg)		



* Different diameter fiber cables are available.

* Due to ongoing product development, RMT reserves the right to modify any technical specifications and dimensions

* Alternate Optic Configurations: Cutting Capacity may vary depending on optic system settings. Working capacities may be higher or lower depending on the configuration.

** Conservative cutting capacities may vary depending on optic system settings. Working capacities may be higher or lower depending on the configuration.